

9408 Eurosert

Steel · Large flange · Splined · Open end
M3 - M10

Features

- Designed to provide load bearing threads in thin sheet materials
- Double diameter body and lead-in chamfer provide easy insertion into hole
- Splined body improves torque-to-turn resistance in softer materials such as aluminium when compared to plain body inserts and improves electrical continuity in sheet metal fixings
- Large flange provides a load bearing surface and reinforces the hole to prevent push-out

Material

- Low carbon steel, zinc plated, clear trivalent passivated
(DIN EN 10263-2 Qst 34-3, BS EN/DIN 10263-2 C8C, Werkstoff 1.0213, SAE 1008)

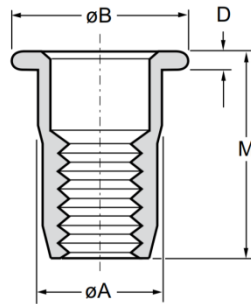

Before Placement

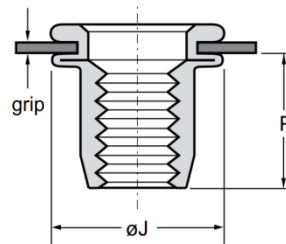

After Placement

Part No.	Thread Size	Grip Range		Hole Size	øA	øB	D	øJ	M	P
		min.	max.	+0.1 / -0	max.	max.	±0.13	max.	nom.	max.
09408-72314	M3 x 0.5	0.25	2.00	5.00	4.95	8.20	0.75	7.40	10.50	6.00
09408-72415	M4 x 0.7	0.25	3.00	6.00	5.95	9.20	0.75	8.80	11.50	7.10
09408-72417		3.00	4.50						13.00	
09408-72517	M5 x 0.8	0.25	3.00	7.00	6.95	10.20	1.00	10.20	13.00	7.90
09408-72520		3.00	5.50						15.50	
09408-72621	M6 x 1.0	0.50	3.00	9.00	8.95	13.20	1.50	12.70	16.00	9.40
09408-72623		3.00	5.50						18.50	
09408-72822	M8 x 1.25	0.50	3.00	11.00	10.95	16.40	1.50	15.00	17.50	11.00
09408-72825		3.00	5.50						20.00	
09408-72028	M10 x 1.5	0.50	3.50	13.00	12.95	18.90	2.25	17.50	22.00	14.50
09408-72031		3.50	6.00						25.00	

Thread Size	Max. torque	Pull-out	Torque-to-turn	Push-out
	Nm max.			
M3 x 0.5	1.5	4.2	1.1	1.8
M4 x 0.7	5.1	5.5	2.2	2.9
M5 x 0.8	7.9	8.0	3.4	4.2
M6 x 1.0	12.4	10.8	4.7	6.5
M8 x 1.25	32.0	12.5	6.8	7.9
M10 x 1.5	45.0	17.3	16.7	10.7